

# Soils Map

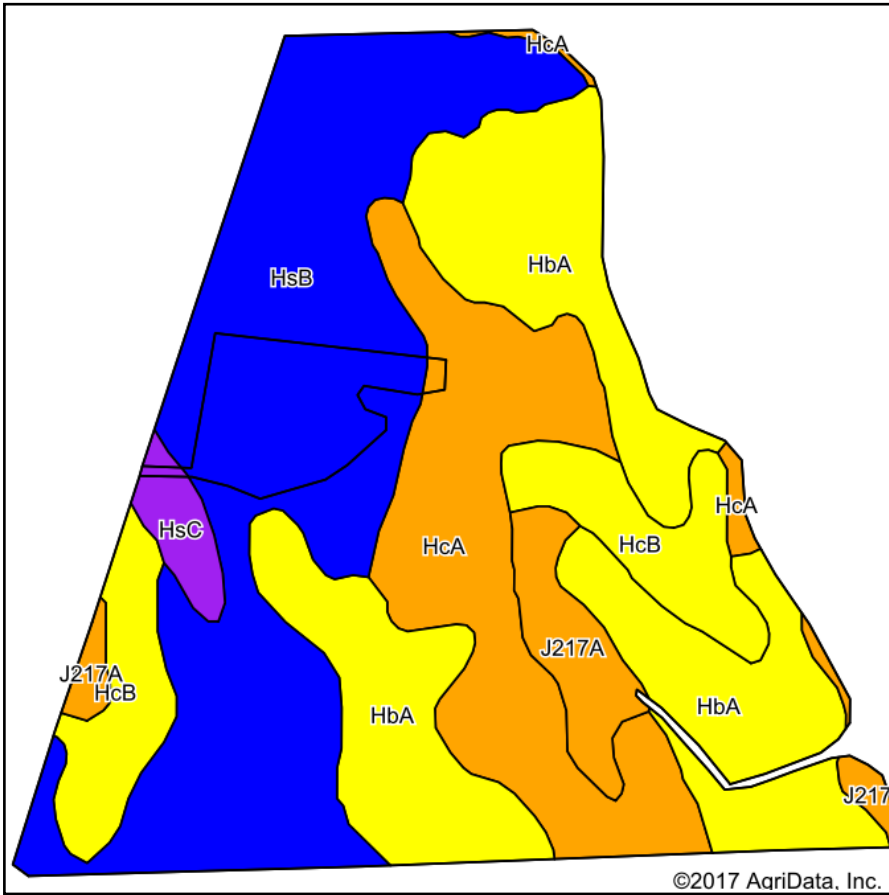

Soils data provided by USDA and NRCS.

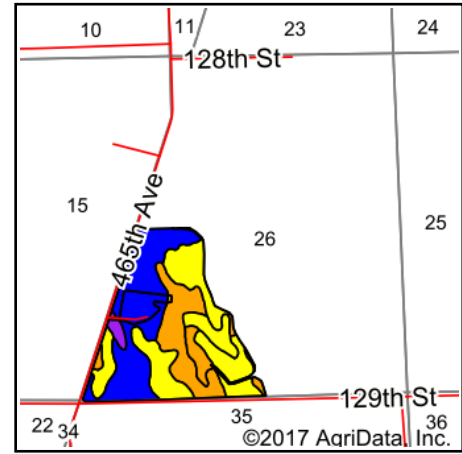





State: **South Dakota**  
 County: **Roberts**  
 Location: **26-124N-50W**  
 Township: **Becker**  
 Acres: **110.35**  
 Date: **12/13/2017**

Dakota View  
 Realty & Auctions  
 DakotaViewRealty.com

Maps Provided By:  
  
 CUSTOMIZED ONLINE MAPPING  
 © AgriData, Inc. 2017 www.AgriDataInc.com

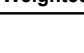

## Area Symbol: SD109, Soil Area Version: 18

Code	Soil Description	Acres	Percent of field	PI Legend	Non-Irr Class *c	Range Production (lbs/acre/yr)	Productivity Index	State Productivity Index	Corn	Soybeans
HsB	Esmond-Heimdal-Sisseton complex, 2 to 6 percent slopes	39.35	35.7%		IIIe	3391	81	67		
HbA	Hamerly-Tonka complex, 0 to 3 percent slopes	32.17	29.2%		IIs	4554	69	57	70	23
HcA	Hamerly-Vallers loams, 0 to 2 percent slopes	20.40	18.5%		IIs	4494	71	59	70	22
HcB	Hamerly-Vallers loams, 2 to 4 percent slopes	10.68	9.7%		IIs	4494	64	53	64	21
J217A	Parnell silty clay loam, occasionally ponded, 0 to 1 percent slopes	5.70	5.2%		IIIw	6480	71	59		
HsC	Esmond-Sisseton-Heimdal, complex, 2 to 12 percent slopes, moderately eroded	2.05	1.9%		IVe	3371	58	48		
<b>Weighted Average</b>						<b>4199.9</b>	<b>73.1</b>	<b>60.5</b>	<b>39.5</b>	<b>12.8</b>

\*c: Using Capabilities Class Dominant Condition Aggregation Method

Soils data provided by USDA and NRCS.