

Soils Map

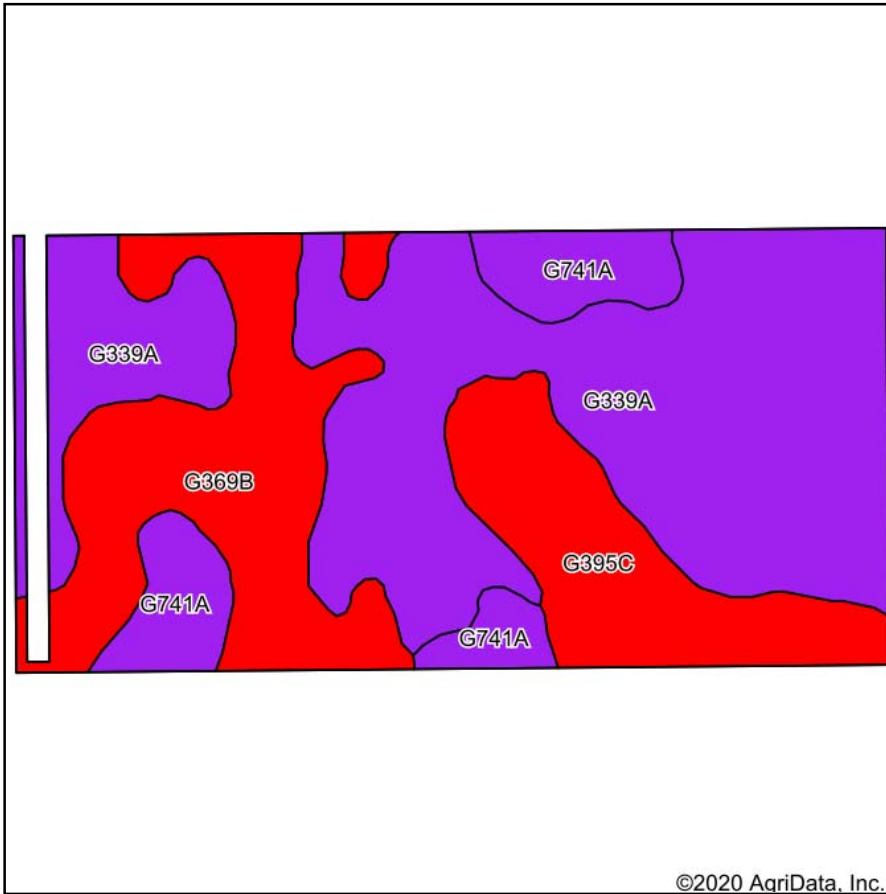

Soils data provided by USDA and NRCS.

©2020 AgriData, Inc.

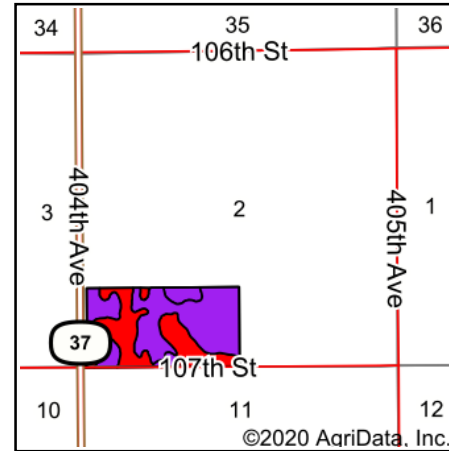

State: **South Dakota**
 County: **Brown**
 Location: **2-127N-61W**
 Township: **Lansing**
 Acres: **78.03**
 Date: **7/25/2020**



Area Symbol: SD013. Soil Area Version: 25										
Code	Soil Description	Acres	Percent of field	PI Legend	Non-Irr Class *c	Range Production (lbs/acre/yr)	Productivity Index	Cor n	Soybeans	*n NCCPI Soybeans
G339A	Ulen fine sandy loam, 0 to 2 percent slopes	41.59	53.3%		IIIe	3964	58			27
G369B	Hecla-Garborg loamy fine sands, 0 to 6 percent slopes	17.33	22.2%		IVe	3674	49			24
G395C	Maddock-Hecla-Garborg loamy fine sands, 2 to 9 percent slopes	11.30	14.5%		IVe	3555	41	17	6	23
G741A	Towner, silty substratum-Hecla loamy fine sands, 0 to 2 percent slopes	7.81	10.0%		IVe	3304	55	50	19	30
Weighted Average						3774.3	53.2	7.5	2.8	*n 26.1

*n: The aggregation method is "Weighted Average using major components"

*c: Using Capabilities Class Dominant Condition Aggregation Method

Soils data provided by USDA and NRCS.