

Soils Map

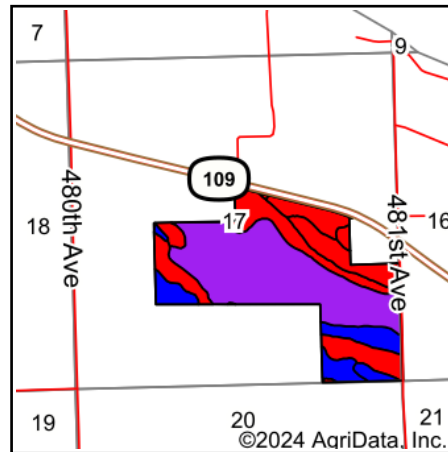

State: **South Dakota**
 County: **Roberts**
 Location: **17-122N-47W**
 Township: **Lockwood**
 Acres: **158.35**
 Date: **3/7/2024**

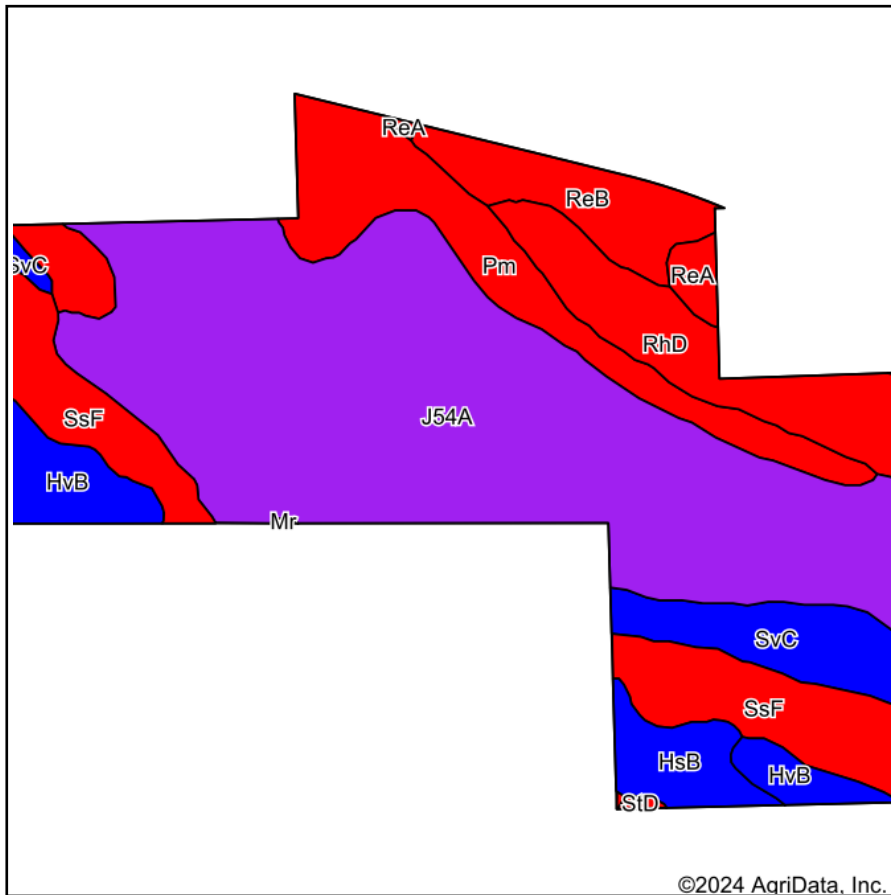

Maps Provided By:



Soils data provided by USDA and NRCS.

Area Symbol: SD109, Soil Area Version: 24

Code	Soil Description	Acres	Percent of field	PI Legend	Non-Irr Class *c	Irr Class *c	Range Production (lbs/acre/yr)	Productivity Index	Corn Bu	Soybeans Bu	*n NCCPI Soybeans
J54A	Marysland loam, occasionally ponded, 0 to 1 percent slopes	77.64	49.0%		IIIw		5218	59			32
Pm	Playmoor silty clay loam	18.61	11.8%		IVw		4430	35	29	8	35
SsF	Sisseton-Esmond complex, 12 to 40 percent slopes	17.98	11.4%		VIIe		3152	23			14
RhD	Renshaw-Sioux loams, 9 to 21 percent slopes	12.87	8.1%		VIe		2329	20	6	2	19
SvC	Svea loam, 5 to 9 percent slopes	8.77	5.5%		IIIe		3515	86	74	28	58
ReB	Renshaw loam, 1 to 6 percent slopes	8.16	5.2%		IVs	IVs	2496	39			29
HvB	Heimdal-Svea loams, 2 to 6 percent slopes	7.49	4.7%		IIe		3825	83	82	31	53
HsB	Esmond-Heimdal-Sisseton complex, 2 to 6 percent slopes	4.99	3.2%		IIIe		3391	81			53
ReA	Renshaw loam, 0 to 2 percent slopes	1.63	1.0%		IIIs	IIIs	2730	43			31
StD	Sisseton-Esmond-Heimdal, complex, 6 to 20 percent slopes, moderately eroded	0.21	0.1%		IVe		3324	43			43
Weighted Average					3.82	*-	4269.8	51	11.9	4.1	*n 32.2

*n: The aggregation method is "Weighted Average using all components"

*c: Using Capabilities Class Dominant Condition Aggregation Method

*-: Irr Class weighted average cannot be calculated on the current soils data due to missing data.

Soils data provided by USDA and NRCS.