

# Soils Map

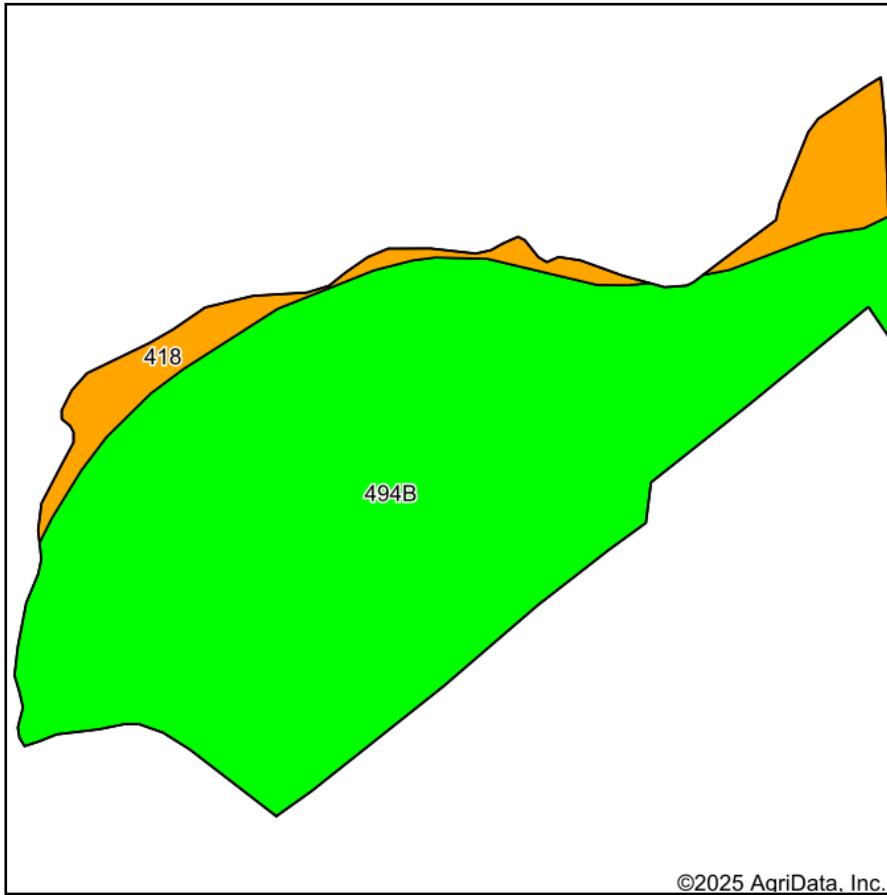

Soils data provided by USDA and NRCS.

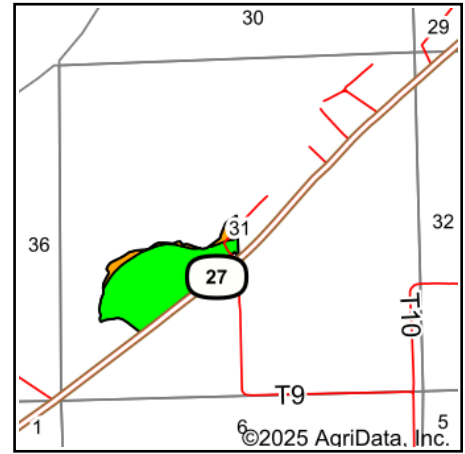

State: **Minnesota**  
 County: **Traverse**  
 Location: **31-126N-48W**  
 Township: **Windsor**  
 Acres: **41.39**  
 Date: **6/2/2025**

Dakota View  
 Realty & Auctions  
 DakotaViewRealty.com

Maps Provided By:

**surety**  
 CUSTOMIZED ONLINE MAPPING  
 © AgriData, Inc. 2023 www.AgriDataInc.com



Area Symbol: MN155, Soil Area Version: 19

Code	Soil Description	Acres	Percent of field	PI Legend	Non-Irr Class *c	Range Production (lbs/acre/yr)	Productivity Index	*n NCCPI Soybeans
494B	Darnen loam, 1 to 6 percent slopes	37.13	89.7%		Ile	3635	99	78
418	Lamoure silty clay loam, 0 to 2 percent slopes, occasionally flooded	4.26	10.3%		IIIw	5316	78	75
Weighted Average					2.10	3808	96.8	*n 77.7

\*n: The aggregation method is "Weighted Average using all components"

\*c: Using Capabilities Class Dominant Condition Aggregation Method